



www.guardian.ru



## STEEL DOORS

Qualified decisions

### Content

|  |    |   |     |
|--|----|---|-----|
| About Guardian   | 4  | Plaza panel boards, with mirror                       | 70  |
| Awards of Guardian   | 6  | Monarch panel boards                                  | 72  |
| Recommendations of Guardian                                      | 8  | Royal panel boards                                    | 74  |
| Steel plate door «Factor»  | 10 | Medina panel boards                                   | 76  |
| Steel plate door DS 1  | 12 | Valencia panel boards                                 | 78  |
| Steel plate door DS 1 with opening from the inside               | 13 | Florence panel boards                                 | 80  |
| Steel plate door DS 2  | 14 | Provence panel boards                                 | 82  |
| Steel plate door DS 3  | 15 | Nika panel boards                                     | 84  |
| Steel plate door DS 3U   | 16 | Premier panel boards                                  | 86  |
| Steel plate door DS 4  | 17 | Geneva panel boards                                   | 88  |
| Steel plate door DS 6  | 18 | Quadro panel boards                                   | 90  |
| Steel plate door DS 7 with opening from the inside               | 19 | Tetra panel boards                                    | 92  |
| Steel plate door DS 8U   | 20 | Legend panel boards                                   | 94  |
| Steel plate door DS 9  | 21 | Alexandria panel boards                               | 96  |
| Steel plate door DS 10   | 22 | Athens Panel Boards                                   | 98  |
| Steel plate door DS PPJ-2  | 23 | Mistral Panel Boards                                  | 100 |
| Steel plate door DS PPJ-E  | 24 | Panel boards 16 mm (FSh, FL, FK); 12 mm (FSh, FL, FK) | 102 |
| Comparative table of the door assemblies DS                      | 25 | Respect panel boards                                  | 104 |
| Decorative finish by metal                                       | 26 | Fusion panel boards                                   | 106 |
| Decorative finish by metal with wrought elements                 | 28 | Octave panel boards                                   | 108 |
| Decorative finish by pressure method                             | 30 | Victory panel boards                                  | 110 |
| Decorative finish by metal with laser-beam cutting               | 32 | Neo panel boards                                      | 112 |
| Decorative finish by Sphere metal                                | 34 | Enigma panel boards                                   | 114 |
| Decorative finish by Art metal                                   | 36 | ML, Sparta, Matador panel boards                      | 116 |
| Decorative finish by Prague metal                                | 38 | Metrica panel boards                                  | 118 |
| Decorative finish by metal with the window and wrought elements  | 40 | LM panel boards                                       | 119 |
| Fortune  | 42 | Maya panel boards                                     | 120 |
| Byzantium  | 44 | Saga Panel Boards                                     | 122 |
| Decorative finish by metal with the window and add-on components | 45 | Vega panel boards                                     | 124 |
| Stained-glass window   | 46 | Panel boards FSh, FL, FK                              | 126 |
| Senator panel boards   | 48 | Panel boards without pattern                          | 128 |
| Aeropolis panel boards   | 50 | Ready-made solution/door «Prestige 01»                | 130 |
| Solid oak panel boards   | 52 | Ready-made solution/door «Prestige 02»                | 131 |
| Solid pine panel boards  | 54 | Ready-made solution/door «Prestige 03»                | 132 |
| Aquitania panel boards   | 56 | Ready-made solution/door «Stealth»                    | 134 |
| Naples panel boards  | 58 | Ready-made solution/door «Palace»                     | 136 |
| Palermo panel boards   | 60 | Door latches  | 138 |
| Italy panel boards   | 62 | Door viewers  | 142 |
| Venice panel boards, with mirror                                 | 64 | Rotators, door bolts, changeable mechanisms           | 143 |
| Verona panel boards  | 66 | Door handles  | 144 |
| Narcissus panel boards, with mirror                              | 68 | Door trim, precast door frames, moulding for doors    | 146 |



www.guardian.ru

*In this catalogue we present the products of Guardian company.*

Our company established in 1994 was one of the first companies in Russia that build a unique plant that is now located on the area of over 50, 000 square meters in Yoshkar-Ola, the Mari El Republic. The plant of Guardian company includes facilities for the production of steel plate doors (Portal, CJSC), lockes and door furniture (Tiara, LLC), as well as the woodworking industry, specializing in the production of design panel boards for the steel plate doors (Guardian-DOZ, LLC).

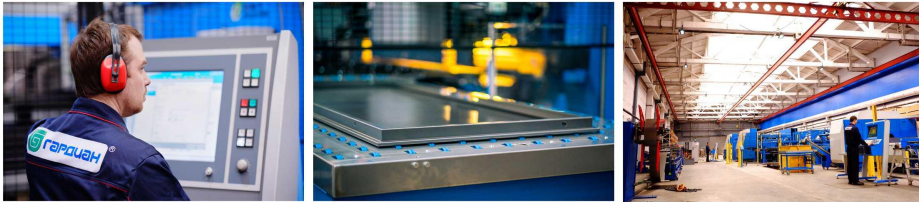

Production of Guardian is made of high quality raw materials of the best domestic and foreign manufacturers using the modern high-precision equipment allowing to provide the verified precision of hole punching, high-quality spot welding, minimum clearances and perfect geometrical arrangement of the door.



The use of high-tech equipment allows the company to provide the customers with the fundamentally new door models, the quality of which can not be repeated in the competitors' production conditions.

The company applies the latest scientific developments, technological achievements and takes into account all the design trends.

Guardian offers the largest product range of doors in the Russian market - from the economy to exclusive options. A wide range of sizes allows to take orders for the door for any opening.



In this catalog you will find the detailed information and be able to easily navigate through the characteristics of the doors and variety of finishes. The catalogue will help you to choose the best door option for your house, apartment or office, and you will be able to easily accept an order from any customer!







www.guardian.ru

### Awards of «Guardian»



In order to confirm our high quality, we actively participate in the specialized international exhibitions and receive the highest awards. For already 10 years all our products are the winners of the contest «The best 100 products of Russia». Steel plate doors made by Guardian were recognized as the best Russian doors and awarded with the gold and platinum quality marks of the International Exhibition «All-Russia Brand (the IIIrd millennium)». The quality mark of the XXI century». A lot of developments of our design department are unique, it is confirmed by the patents. Participation in the voluntary certification confirms our confidence in the quality of the manufactured products. Guardian company has successfully passed the quality management system certification according to the international standards:  
 2008 - GOST R ISO 9001-2001,  
 2011 - GOST R ISO 9001-2008,  
 2013 - GOST ISO 9001-2011,  
 2016 - GOST R ISO 9001-2015.



### Steel plate doors      Locks      Design panel boards

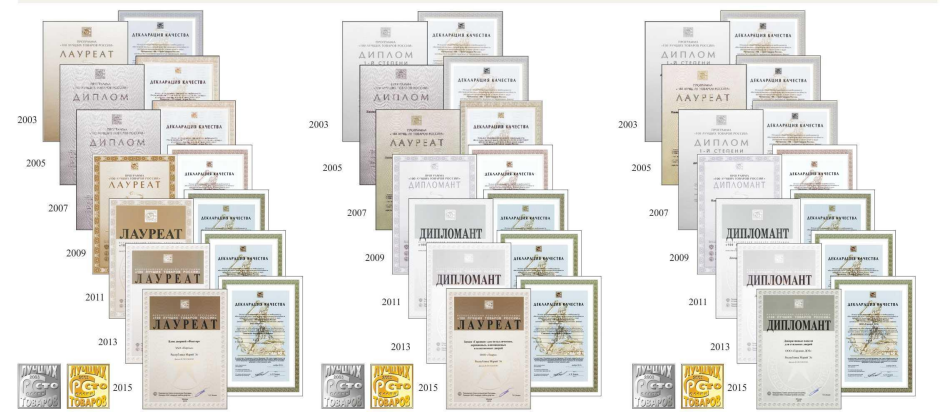



www.guardian.ru

### Recommendations of Guardian

We are sure that with our help you can create a unique image of own reliable and beautiful steel plate door from Guardian. For this purpose, we offer to pay attention to the following recommendations on selection of a steel plate door.

Steel plate doors from Guardian provide not only the heat and acoustic insulation, allowing to establish the comfortable environment for working and living, but also the high-end protection. We produce reinforced, burglar-resistant steel plate doors both for homes and offices, as well as for installation in the banks and other institutions the protection of which requires the door structures with maximum resistance to force opening. Moreover, we offer a wide product range of the exterior and interior finishes, so you can choose a beautiful and reliable door from Guardian, ideally suited to the premises interior and conforming to your requirements for strength and functional characteristics of the door.

#### Design of the doors

We have developed the following designs of steel plate doors:

«Factor» is the unique design that has no analogues in Russia, made on the latest hi-tech European production line for the entrance metal doors. Factory quality at a competitive price.

DS 1 and DS 1 VO are not very expensive, but reliable doors of economy class;

DS 2, DS 3, DS 7, DS 9 are the enhanced doors protected from the vandal and intellectual force opening; DS 3U, DS 8U, DS 4 are the burglar-resistant doors with the I, II and III class of force opening resistance, complying with the requirements of the bank protection.

DS 6, DS 10 are the door assemblies with a thermal break, with the new thermal and acoustic insulating properties. They can be installed as a «street» doors without the cold vestibule, but this unique design eliminates the freezing of the door assembly and frost buildup on the door surface. A brief description of the design of steel plate doors from «Guardian» can be found in this catalogue, details on the web-site: [www.guardian.ru](http://www.guardian.ru).

#### Door latches

Each door design is developed with a specific set of locks. These can be the Guardian own-produced latches and the locks of the Italian manufacturers «Cisa» and «Mottura». When choosing the latch we recommend to pay attention to the class and secrecy: the more combinations, the higher is secrecy. Please, note that some models of the latches have the decoding function, that is, if the owner loses the key, he/she does not need to change the whole latch, they just need to change the latch secret. A brief description of the latches installed in the Guardian steel plate doors is included in this catalogue or on the website: [www.guardian.ru](http://www.guardian.ru).

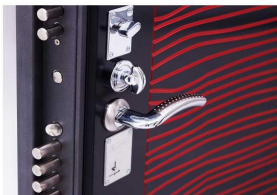

#### Accessories

The pads, door handles, rotators, door viewers, cylinders, decorative front doorsteps may be made in the brass or chrome color. It is recommended to choose the accessories within the same color scheme suitable for decorative finishing.

#### External decorative finishing

Steel plate doors from «Guardian» are covered with the powder-polymer coating with high protective and decorative properties. In order to improve the resistance of the coating, especially on the doors, installed directly on the street, we recommend to use the powder varnish that gives the coating additional strength and practicality. Please note that the steel plate door from «Guardian» can be decorated with decorative metal finish or design panel board from the outside.

#### Design panel boards

If you want the door to match the premises design, we offer you a variety of design panel boards. For this purpose, we have created more than 25,000 finishes made of solid oak, pine, wood veneer, MDF, plastics and other modern materials. When you select the design panel board, we recommend to focus on the conditions under which it will be operated.

If you plan to install the door as a «street» one, we recommend to choose the panel with weather-resistant coating.

The range of outdoor decorative finishes and interior design panel boards can be found in this catalogue and on the website: [www.guardian.ru](http://www.guardian.ru).

#### Additional options

It is recommended to pay attention to the selection of additional options that will not only improve the aesthetic perception, but also increase the burglar-resistance of the door. For example, you can order hidden door butts that are not visible from the outside. The decorative add-on front doorstep with the logo of Guardian provides the protection of the doorstep coating of the door assembly from abrasion. When ordering the reinforced door DS 3 or DS 3U you can select the anti-theft labyrinth that significantly increases the burglar-resistance of the doors in the case of force opening.

*With concern for you, Guardian.*

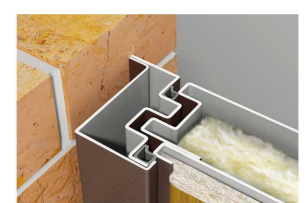

Steel plate door «FACTOR» / laminated metal



Unique structure that is unparalleled in Russia.  
 •3 strength class according to GOST 31173-2003.  
 •Grade 2 in terms of acoustic insulation complying with GOST 31173-2003.  
 •Grade 2 in terms of air impermeability complying with GOST 31173-2003.  
 •Grade 2 in terms of resistance to heat transfer complying with GOST 31173-2003.

- Made without the welding joints using the latest high-precision equipment.
- The original Guardian pads, hidden fastening.
- Reliable and safe Guardian latches.
- Galvanized metal sheet from the best European manufacturers, 5-layer coating.
- Maximum heat and acoustic insulation, rigid polyurethane foam.
- Installation in the opening of any size, the wide prominent door trim 60 mm.

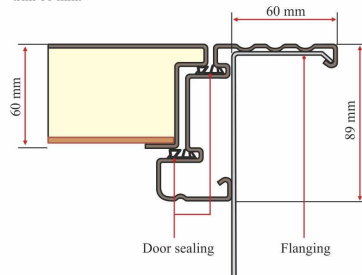

Steel plate door «FACTOR» / painted metal



Unique structure that is unparalleled in Russia.  
 •3 strength class according to GOST 31173-2003.  
 •Grade 2 in terms of acoustic insulation, complying with GOST 31173-2003.  
 •Grade 2 in terms of air impermeability, complying with GOST 31173-2003.  
 •Grade 2 in terms of resistance to heat transfer, complying with GOST 31173-2003.

- Made using the latest high-precision equipment without the welding joints on the leaf.
  - The original Guardian pads, hidden fastening.
  - Reliable and safe Guardian latches.
  - Maximum heat and acoustic insulation with the rigid polyurethane foam.
  - The wide prominent door trim 60 mm can be used for the wide range of sizes.
- Variants of the filling:  
 rigid expanded polyurethane,  
 mineral wool board  
 and honeycomb filler.

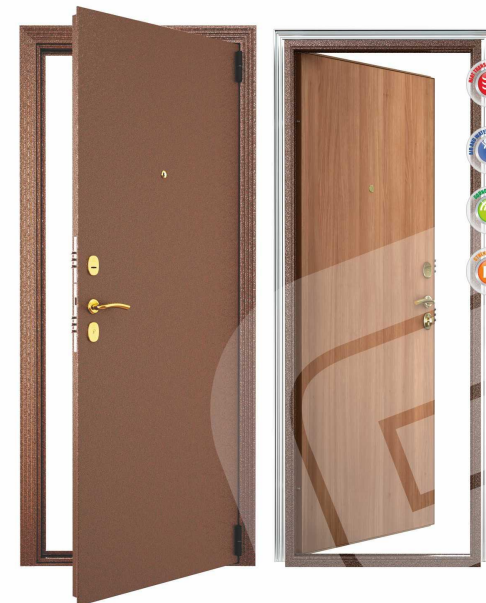
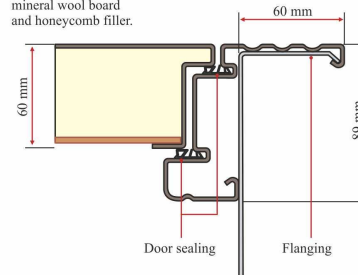



### Steel plate door DS 1



Conforms to the requirements of GOST 31173-2003 «Steel door assemblies». The class of strength – M1, the highest one. Conforms to the requirements of GOST 31173-2003, paragraph 4.2.3. Grade in terms of acoustic insulation index - 2 (30 dB\*).

\*dB is the value characterizing the reduction by the door of sound power level of airborne noise acting on the door.

- The class of strength – the highest one, 1 (M1 according to GOST 31173-2003).
- Class of acoustic insulation - 2 according to GOST 31173-2003, paragraph 4.2.3. - 30 dB.
- Reinforced door assembly – the closed design
- The monolithic leaf, one sheet of metal.
- Insulation - polyurethane foam.
- Anti-theft locks - 2 pcs.
- Door viewer.
- Door butts on the support bearing.
- 6 anchors in the doorframe.

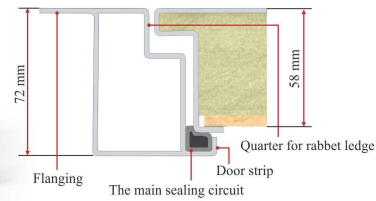

### Steel plate door DS 1 VO

Steel plate door DS 1 VO - with opening from the inside.

- Reinforced door assembly – the closed design.
- The monolithic leaf, one sheet of metal.
- Insulation - polyurethane foam.
- Door viewer.
- Door butts on the support bearing - 2 pcs.
- The sealing circuit.
- 6 anchors in the doorframe.

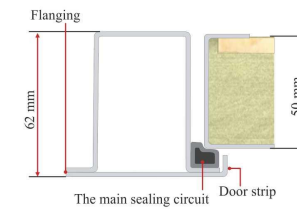
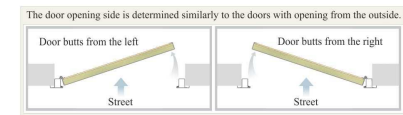

Steel plate door **DS 2**



Conforms to the requirements of GOST 31173-2003 «Steel door assemblies». The class of strength – M1, the highest one. Conforms to the requirements of GOST 31173-2003, paragraph 4.2.3. Grade in terms of acoustic insulation index – the highest grade (40.03 dB\*).

\*dB is the value characterizing the reduction by the door of sound power level of airborne noise acting on the door.

- The class of strength – the highest one, 1 (M1 according to GOST 31173-2003).
- Class of acoustic insulation – the highest one, 1 according to GOST 31173-2003, paragraph 4.2.3. – 40.03 dB.
- Reinforced door assembly – the closed design
- The monolithic leaf, one sheet of metal.
- Insulation – the environmentally sound mineral wool board.
- Stiffening ribs – 3 pcs.
- Anti-theft locks - 3 pcs.
- Two sealing circuits.
- Registered spherical Guardian door butts.
- It is possible to install the armour-plated package.
- 6 anchors in the doorframe.

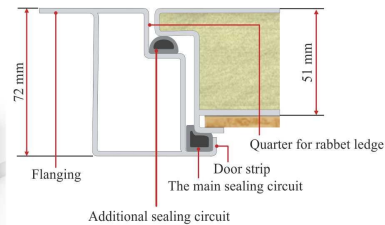

Steel plate door **DS 3**

Conforms to the requirements of GOST 31173-2003 «Steel door assemblies». The class of strength – M1, the highest one.

- The class of strength – the highest one, 1 (M1 according to GOST 31173-2003).
- Reinforced door assembly – the closed design
- The monolithic leaf, two sheets of metal.
- Insulation – the environmentally sound mineral wool board.
- Stiffening ribs – 3 pcs.
- Anti-theft locks - 3 pcs.
- Latches with multipoint closing.
- Two sealing circuits.
- Registered spherical Guardian door butts.
- 6 anchors in the doorframe.

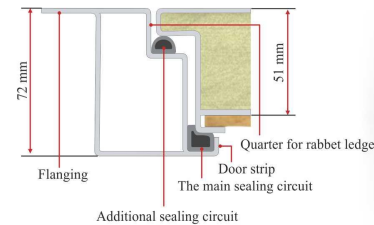

### Steel plate door DS 3U



Conforms to the requirements of GOST R 51113-97 «Bank protective means. Requirements for burglar-resistance and test methods». Grade I in terms of burglar-resistance. Conforms to the requirements of GOST 31173-2003, paragraph 4.2.3. Grade in terms of acoustic insulation index – the highest grade (41 dB\*).

\*dB is the value characterizing the reduction by the door of sound power level of airborne noise acting on the door.

- The class of burglar-resistance – I according to GOST R 51113-97.
- Class of acoustic insulation – the highest one, 1 according to GOST 31173-2003, paragraph 4.2.3. – 41 dB.
- Reinforced door assembly – the closed design.
- The monolythic leaf, two sheets of metal.
- Insulation – the environmentally sound mineral wool board.
- Stiffening ribs – 4 pcs.
- Anti-theft locks - 5 pcs.
- Latches with multipoint closing.
- Armour-plated complex protection against the common defeat methods (armour-plated package).
- Two sealing circuits.
- Registered spherical Guardian door butts.
- 15 cutoff points, 10 attachment points.

The steel plate door DS3U is equipped with the armour-plated package providing the following:

- protection of the latch pocket against the slitting;
- protection of the door latch and door bolt catch locks in the leaf;
- protection of the door latch and door bolt catch locks in the door assembly;
- protection of the latch cylinder mechanism with the armour-plated pad;
- protection of the lever tumbler lock with the armour-plated pad against drilling;
- protection against pressing of the leaf.

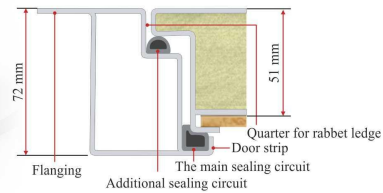

### Steel plate door DS 4

Elite steel burglar-resistant door conforming to the requirements of the 3rd grade of burglar-resistance in accordance with GOST R 51113-97. «Bank protective means. Requirements for burglar-resistance and test methods».

- The class of burglar-resistance – III according to GOST R 51113-97.
- Reinforced door assembly – the closed design.
- The monolythic leaf, three sheets of metal.
- Insulation – the environmentally sound mineral wool board.
- Complete longitudinal and transversal leaf sewing.
- Anti-theft labyrinth.
- Latches with multipoint closing, the deviators – 2 pcs.
- Armour-plated complex protection against the common defeat methods.
- Bulletproof door viewer.
- Two sealing circuits.
- Registered spherical Guardian door butts – 3 pcs.
- 16 cutoff points, 12 attachment points.

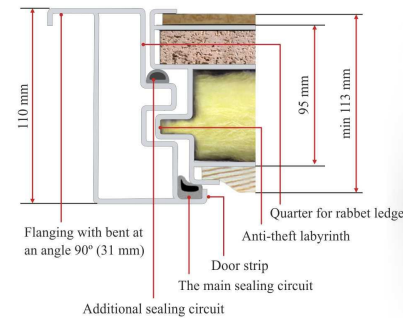



Steel plate door **DS 6**



Conforms to the requirements of GOST 31173-2003, paragraph 4.2.1. The highest grade in terms of heat transfer resistance indicator ( $1.84 \text{ v}^2 \text{ C/W}$ ).

- The highest grade of heat transfer resistance according to GOST 31173-2003.
- Reinforced door assembly – the closed design.
- The monolithic leaf, two sheets of metal.
- Insulation of the door assembly and door leaf with the hard polyurethane foam.
- Thermal separation insert in the leaf and door assembly.
- Anti-theft locks – 3 pcs.
- Three sealing circuits (1 magnet and 2 rubber).
- Registered spherical Guardian door butts – 3 pcs.
- The increased depth of the door assembly (119 mm).
- The increased thickness of the door leaf (103 mm).
- 6 anchors in the doorframe.

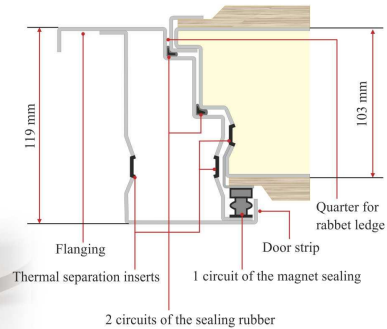

Steel plate door **DS 7 VO**

Steel plate door **DS 7 VO** - with opening from the inside.

- Reinforced door assembly – the closed design.
- The monolithic leaf, two sheets of metal.
- Insulation – the environmentally sound mineral wool board.
- Stiffening ribs – 4 pcs.
- Two sealing circuits.
- Registered spherical Guardian door butts.
- 6 anchors in the doorframe.

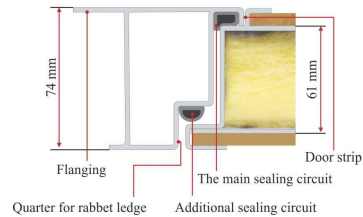

The door opening side is determined similarly to the doors with opening from the outside.

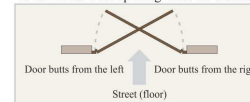

Steel plate door **DS 8 U**

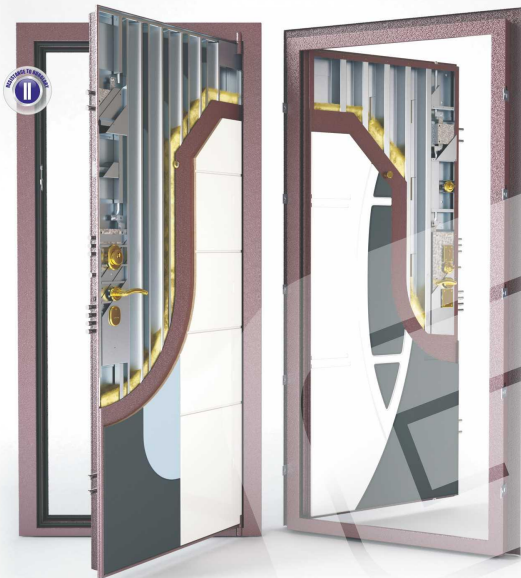

Conforms to the requirements of GOST R 51113-97 «Bank protective means. Requirements for burglar-resistance and test methods». Grade 2 in terms of burglar-resistance.

- The class of burglar-resistance – II according to GOST R 51113-97.
- Reinforced door assembly – the closed design.
- The monolithic leaf, two sheets of metal.
- Insulation – the environmentally sound mineral wool board.
- Stiffening ribs – 5 pcs.
- Solid anti-theft labyrinth.
- Two sealing circuits.
- Latches with multipoint closing the highest grade (4 grade) of resistance against the non-destructive and destructive defeat methods.
- Armour-plated complex protection against the common defeat methods (armour-plated package).
- Deviators – 2 pcs.
- Door butts “Bark” – 2 pcs.
- 15 cutoff points, 10 attachment points.

The steel plate door DS 8U is equipped with the armour-plated package providing the following:

- protection of the latch pocket against the slitting;
- protection of the door latch and door bolt catch locks in the leaf;
- protection of the door latch and door bolt catch locks in the door assembly;
- protection of the latch cylinder mechanism with the armour-plated pad;
- protection of the lever tumbler lock with the armour-plated pad against drilling;
- protection against pressing of the leaf.

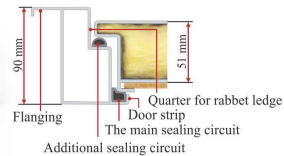

Steel plate door **DS 9**



Conforms to the requirements of GOST 31173-2003, paragraph 4.2.3. Grade in terms of acoustic insulation index – the highest grade (57.8 dB\*).

\*dB is the value characterizing the reduction by the door of sound power level of airborne noise acting on the door.

Conforms to the requirements of GOST 31173-2003, paragraph 4.2.1. Class in terms of heat transfer resistance indicator – the highest on (1.12 m<sup>2</sup>C/W).

- Reinforced door assembly – the closed design.
- The monolithic leaf, two sheets of metal.
- The increased depth of the door assembly (100 mm).
- The increased thickness of the door leaf (from 80 mm).
- Insulation – the environmentally sound mineral wool board.
- Stiffening ribs – 3 pcs.
- Anti-theft locks – 3 pcs.
- Two sealing circuits.
- Registered spherical Guardian door butts – 3 pcs.
- 6 anchors in the doorframe.

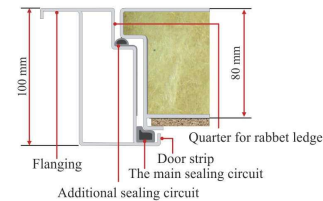

Steel plate door **DS 10**



Conform to the requirements of all-Union State Standard 31173-2003 section 4.2.1., which is the highest rating-factor of heat's conductance impedance factor (1.38 m2 C°/W). M1 quality class.

- Reinforced door assembly – the closed design.
- The monolithic leaf, two sheets of metal.
- Insulation of the door assembly and door leaf with the hard polyurethane foam.
- Thermal separation insert in the leaf and foor assembly.
- Anti-theft locks – 3 pcs.
- Two sealing circuits.
- Registered spherical Guardian door butts – 3 pcs.
- The increased depth of the door assembly (107 mm).
- The increased thickness of the door leaf (87 mm).

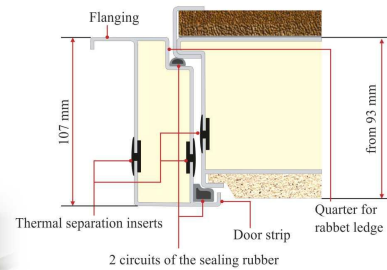

Steel plate door **DS PPJ-2**

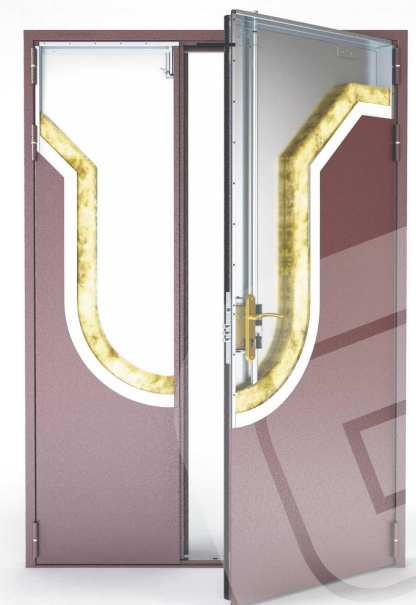

Conforms to the requirements of the technical regulation on the fire safety requirements. Federal Law No.123-Φ3 dated July 22, 2008 with amendments No.117-Φ3 dated July 10, 2012, section 10, article 37, paragraph 2, section 19, article 88, paragraphs 3, 8, 13. The fire resistance grading EI-60.

- The fire resistance grading – not less than 60 minutes.
- The monolithic leaf, two sheets of metal.
- Insulation – the environmentally sound mineral wool board.
- Fireproof gypsum plasterboard.
- Thermal sealing tape.
- Steel band along the door perimeter prevents the deformation of the door leaf under the influence of high temperatures.
- Version – the double-leaf door.
- Door butts on the supporting bearing – 6 pcs.
- The elevation of the unlocked door-case.
- 6 anchors in the doorframe.
- Door check.

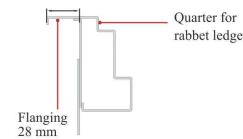





www.guardian.ru

Steel plate door **DS PPJ-E**



**Conforms to the requirements of the technical regulation on the fire safety requirements, Federal Law No.123-ФЗ dated July 22, 2008, article 88, paragraph 2. The fire resistance grading EI-60.**

- The fire resistance grading – not less than 60 minutes.
- The monolithic leaf, two sheets of metal.
- Insulation – the environmentally sound mineral wool board.
- Fireproof gypsum plasterboard.
- Thermal sealing tape.
- Steel band along the door perimeter prevents the deformation of the door leaf under the influence of high temperatures.
- Door closer.
- Version – the single-leaf door.
- Registered spherical Guardian door butts.
- The elevation of the unlocked door-case.

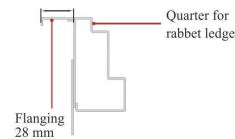

Comparative table of the door assemblies DS

| Door assembly                                       | DS 1   | DS 2   | DS 3   | DS 3V   | DS 4                       | DS 6<br>For the cottages         | DS 7                                    | DS 8V   | DS 9                                      | DS 10<br>For the cottages                 |
|---|--|--|--|---|----------------------------|----------------------------------|---|---|---|---|
| <b>Characteristics</b>                              |  |  |  |   |                            |                                  |   |   |   |   |
| Opening   | From the outside/ from the inside                      | From the outside   | From the outside                                     | From the outside                                  | From the outside           | From the outside                 | From the inside                         | From the outside                                  | From the outside                          | From the outside                          |
| Strength class (GOST 31173-2003) (GOST R 5113-97)   | M 1  | M 1  | M 1  | -   | -                          | No test                          | No test                                 | -   | No test                                   | No test                                   |
| Class of burglar-resistance                         | -  | -  | -  | I class   | III class                  | No test                          | No test                                 | II class  | No test                                   | No test                                   |
| Acoustic insulation class (GOST 31173-2003)         | II class 30 dB   | I class 40,03 dB   | No test  | I class 41 dB                                     | No test                    | No test                          | No test                                 | No test   | I class 57,8 dB                           | No test                                   |
| Class of heat transfer resistance (GOST 31173-2003) | No test  | No test  | No test  | No test   | No test                    | 1 class 1,84 m <sup>2</sup> °C/W | No test                                 | No test   | 1 class 1,12 m <sup>2</sup> °C/W          | 1 class 1,38 m <sup>2</sup> °C/W          |
| <b>Design features</b>                              |  |  |  |   |                            |                                  |   |   |   |   |
| Depth of the door assembly                          | 72 mm / 62 mm  | 72 mm  | 72 mm  | 72 mm   | 110 mm                     | 119 mm                           | 74 mm                                   | 90 mm   | 100 mm                                    | 107 mm                                    |
| Width of the door leaf                              | 58 mm / 50 mm  | from 51. If there is the smooth metal sheet from the inside - 52 mm      | from 57 mm   | from 57 mm  | from 113 mm                | from 109 mm                      | from 67 mm                              | from 57 mm  | from 87 mm                                | from 93 mm                                |
| Number of the metal sheets                          | 2 - if there is the smooth metal sheet from the inside | 2  | 2  | 2   | 3                          | 2                                | 2                                       | 2   | 2   | 2   |
| Stiffening ribs                                     | -  | 3  | 3  | 4   | 4                          | -                                | 4                                       | 5   | 3   | -   |
| Internal filling                                    | Hard polyurethane foam                                 | Mineral wool board   | Mineral wool board                                   | Mineral wool board                                | Mineral wool board         | Hard polyurethane foam           | Mineral wool board                      | Mineral wool board                                | Mineral wool board                        | Hard polyurethane foam                    |
| Anti-theft locks                                    | 2  | 3  | The solid anti-theft labyrinth is possible           | The solid anti-theft labyrinth is possible        | Solid anti-theft labyrinth | 3                                | -                                       | The solid anti-theft labyrinth is possible        | 3   | 3   |
| Sealing   | 1 circuit in the basic set. 2 circuits are possible    | 2 circuits. 1 circuit if there is the smooth metal sheet from the inside | 2 circuits   | 2 circuits  | 2 circuits                 | 2 circuits                       | 2 circuits                              | 2 circuits  | 2 circuits                                | 2 circuits                                |
| Brand, class of lock (GOST 5089-2003)               | «Guardian» 2, 4 classes                                | «Guardian» 2, 3, 4 classes   | «Guardian» 2, 3, 4 classes, «Cisa», «Motura» 4 class | «Guardian» 3, 4 classes, «Cisa», «Motura» 4 class | «Guardian» 3, 4 classes    | «Guardian» 3, 4 classes          | «Guardian» 3, 4 classes, «Cisa» 4 class | «Guardian» 3, 4 classes, «Cisa», «Motura» 4 class | «Guardian» 3, 4 classes                   | «Guardian» 3, 4 classes                   |
| Possibility to re-encode the lock                   | -  | -  | ✓  | ✓   | ✓                          | ✓                                | ✓                                       | ✓   | ✓   | ✓   |
| Door claying in 3 directions (vertical drives)      | -  | -  | ✓  | ✓   | ✓                          | -                                | ✓                                       | ✓   | ✓   | -   |
| Deviators   | -  | -  | -  | -   | In the basic set           | -                                | -                                       | Possible  | -   | -   |
| Armour-plated package (armour-plated pad)           | -  | Possible   | -  | In the basic set                                  | -                          | -                                | Possible                                | In the basic set                                  | Possible                                  | -   |
| <b>Appearance</b>                                   |  |  |  |   |                            |                                  |   |   |   |   |
| External finishing                                  | Metal  | Metal or design panel board  | Metal or design panel board                          | Metal or design panel board                       | Design panel board         | Metal or design panel board      | Metal or design panel board             | Metal or design panel board                       | Metal or design panel board               | Metal or design panel board               |
| Internal finishing                                  | Design panel board or smooth metal sheet               | Design panel board or smooth metal sheet                                 | Design panel board                                   | Design panel board                                | Design panel board         | Design panel board               | Design panel board                      | Design panel board                                | Design panel board                        | Design panel board                        |
| Possibility to change the internal panel board      | -  | ✓  | ✓  | ✓   | ✓                          | ✓                                | ✓                                       | ✓   | ✓   | ✓   |
| Possibility to manufacture with the window          | -  | ✓  | ✓  | -   | -                          | -                                | -                                       | -   | -   | -   |
| <b>Door butts</b>                                   |  |  |  |   |                            |                                  |   |   |   |   |
| Spherical «Guardian»                                | -  | 2 pcs in the basic set. 3 pcs is possible                                | 2 pcs in the basic set. 3 pcs is possible            | 2 pcs in the basic set. 3 pcs is possible         | 3 pcs in the basic set     | 3 pcs in the basic set           | 3 pcs in the basic set                  | -   | 2 pcs in the basic set. 3 pcs is possible | 2 pcs in the basic set. 3 pcs is possible |
| On the supporting bearing                           | 2 pcs always   | Possible 2 pcs   | Possible 2 pcs                                       | Possible 2 pcs                                    | -                          | -                                | -                                       | -   | -   | -   |
| Hidden door butts (Israel)                          | -  | Possible 2 or 3 pcs  | Possible 2 or 3 pcs                                  | -   | -                          | -                                | Possible 4 pcs                          | -   | -   | -   |
| Door butts «Barko»                                  | -  | -  | -  | -   | -                          | -                                | -                                       | 2 pcs always                                      | -   | -   |



NEW!

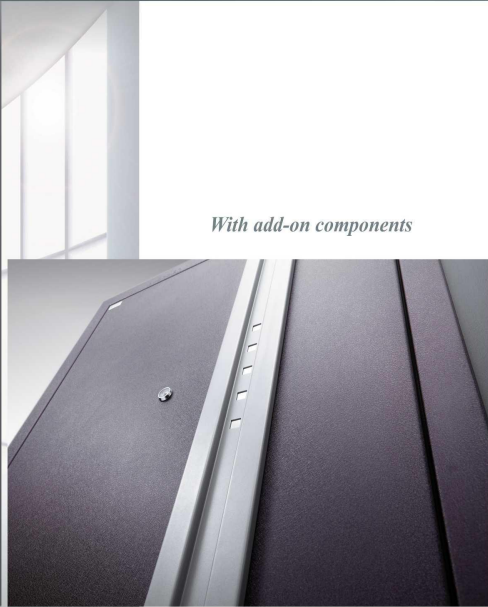

With add-on components



80



83



87



105



«City» 131



«Tower» 132



163

*Decorative finish by metal*



*With add-on wrought elements  
decorated with patina*



114



129



130



«Emir»143



146



152





Decorative finish by metal

www.guardian.ru



NEW!

Made by the pressure method

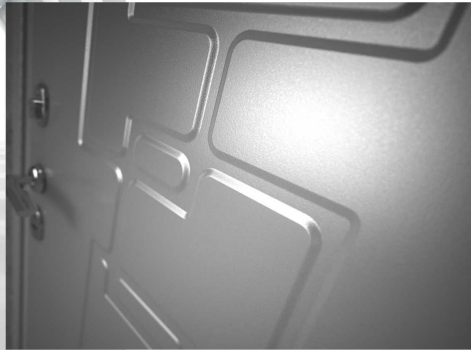

133



134



135



136



137



144



145



164

NEW!



165

NEW!

Decorative finish by metal

With add-on components of laser-beam cutting and stainless steel

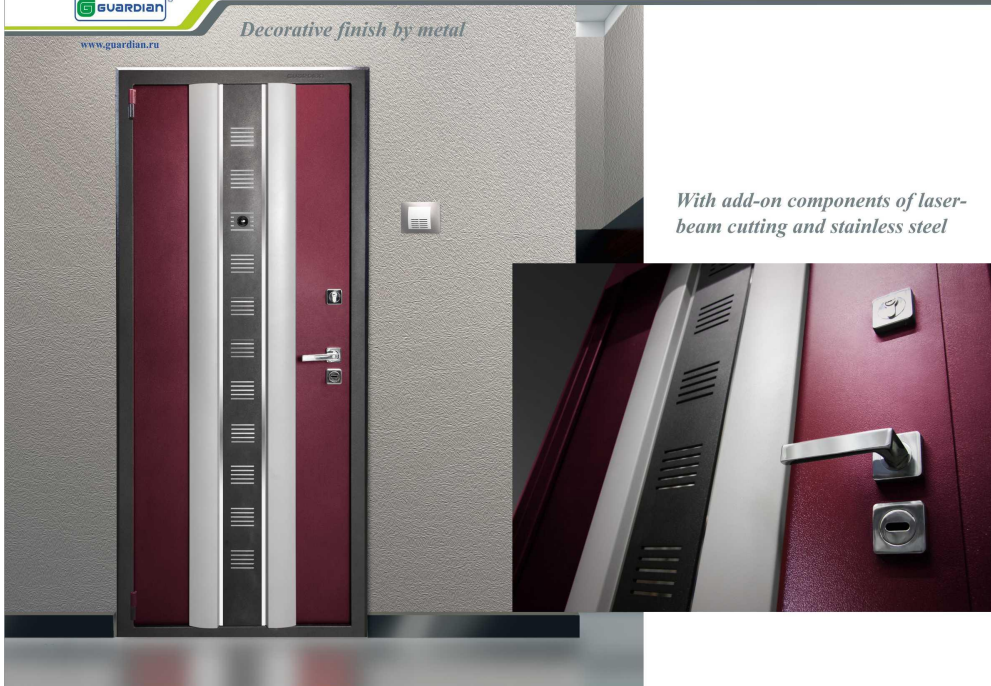

«Magic» 141



«Empire» 142



147



148



149



156



«Tower 2» 157



158



159

Decorative finish by metal

### № 138 Sphere

With the 3D add-on metal element

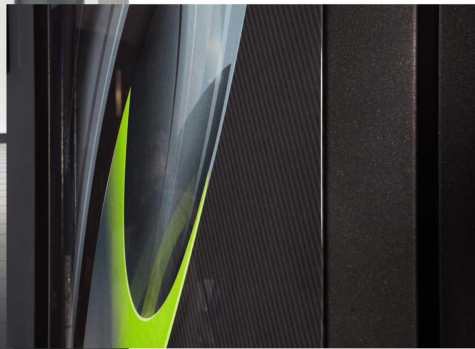



***№ 155 Art***  
*With the 3D add-on metal element  
and aerodecoration*



«Green phantom»



«Frigate»



«Flame»





**№ 139 Prague**

*With the 3D add-on metal elements,  
aerodecoration and solid or MDF  
insertions*



«Renaissance»



«Panthers»



«Venices»



«Castles»



«Professional»



«Jazz»



«Old town»

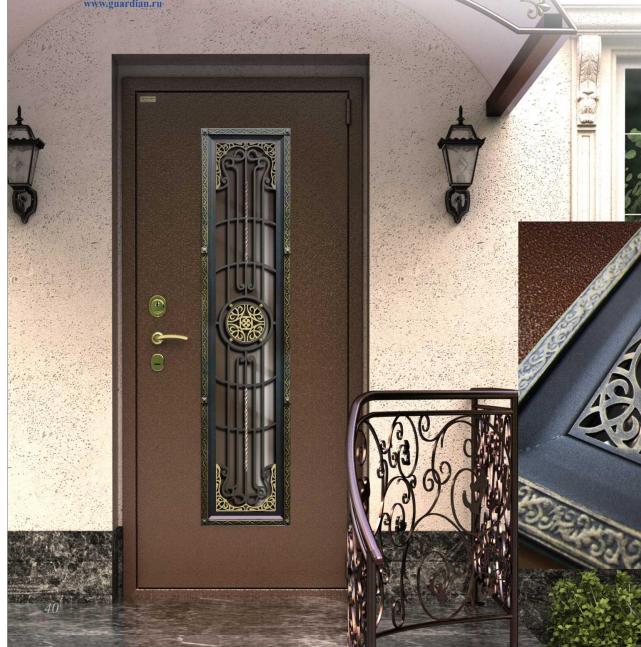

*Finish with the window  
and wrought elements*

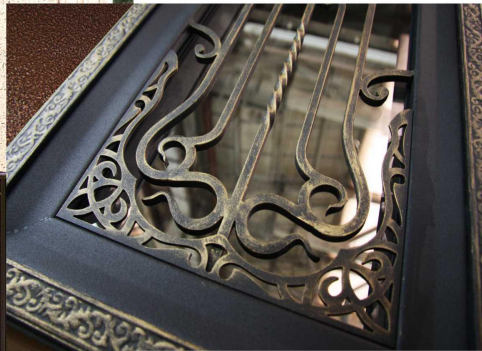

115



118



120



123



124



127



«Mask»140



150



151



161



162

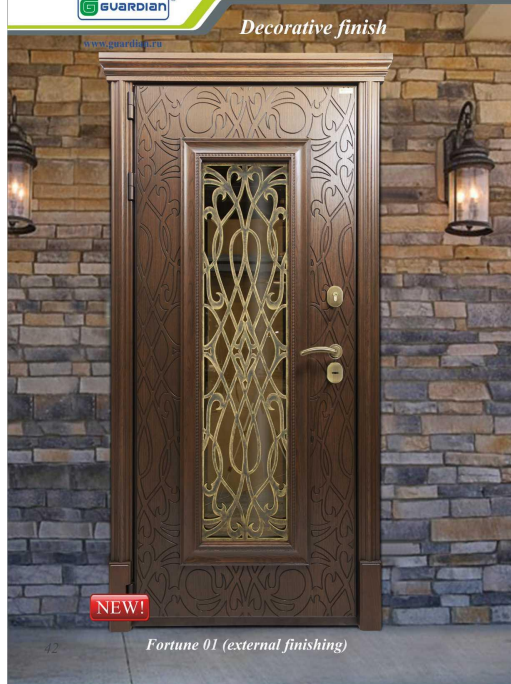

Fortune 01 (external finishing)

### Fortune

- Finishing is of veneered panels and frame of solid oak with a weather-resistant coating.
- The grid is created using a laser cutter, and is decorated with a patina forged.

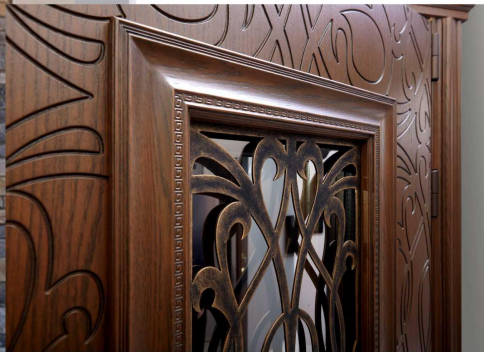

### Fortune

- Three-chambered glass unit

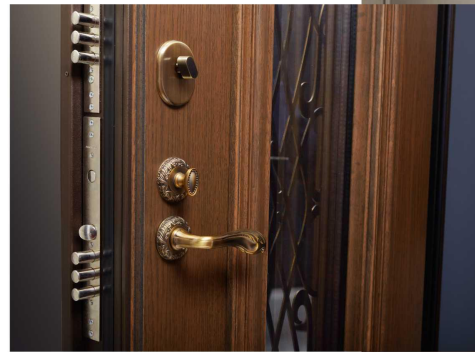

Fortune 02 (internal finishing)



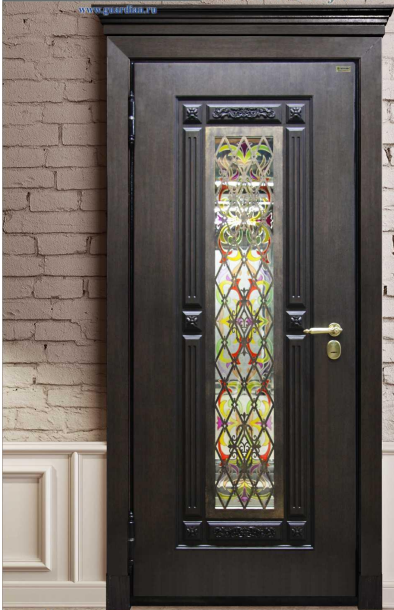

External finishing



Internal finishing



**Byzantium**

Finish with the windows and laser-beam cutting elements

**№ 160**

Finish with the windows and add-on components

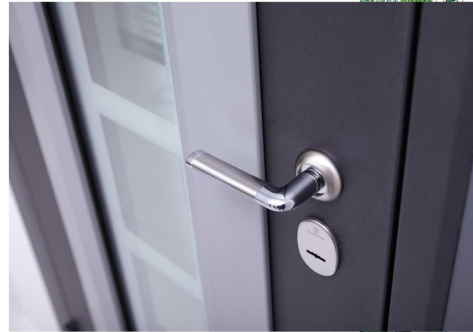





*Stained-glass window*

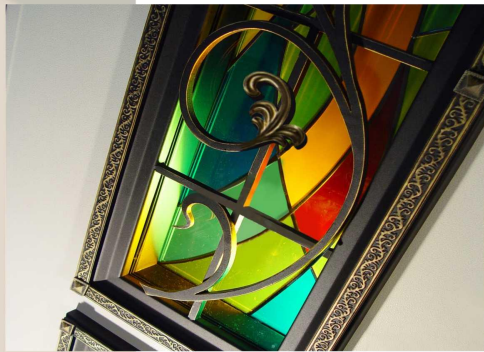

Stained-glass for finishing  
No 115, 118, 120, 123, 127  
«Goodwin»



Stained-glass 01 for finishing  
No 140 «Mask»



Stained-glass 02 for finishing  
No 140 «Mask»



Stained-glass for finishing  
No 150, 161 «Mascot»



Stained-glass for finishing  
No 151, 161 «Oasis»



Stained-glass (pouring)  
for finishing «Byzantium»

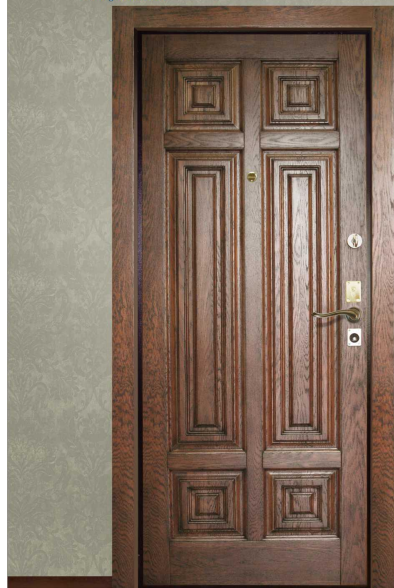

Panel boards  
**Senator**  
Solid oak or pine



01



02



03



04



05



06

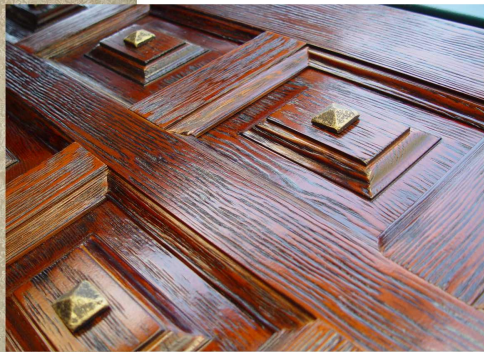
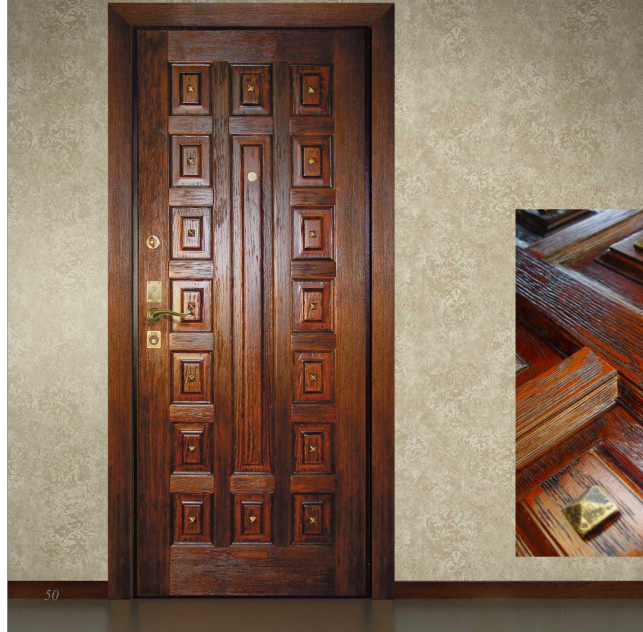

Panel boards  
**Acropolis**  
Solid pine  
With strong prominent wood structure  
and partial removal of soft fibers



01



02



03



04



Panel boards  
**Solid oak**

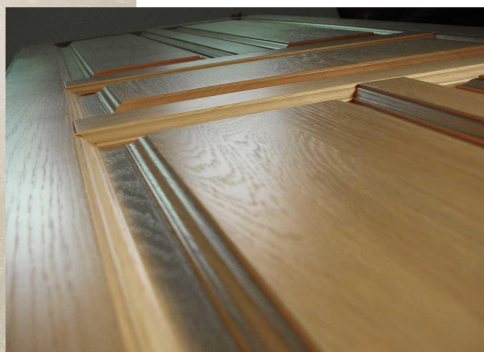

02



04



06



08



09



11



15



18



Panel boards  
**Solid pine**



02



05



06



08



09

Panel boards  
**Aquitania**  
Multilayer plywood

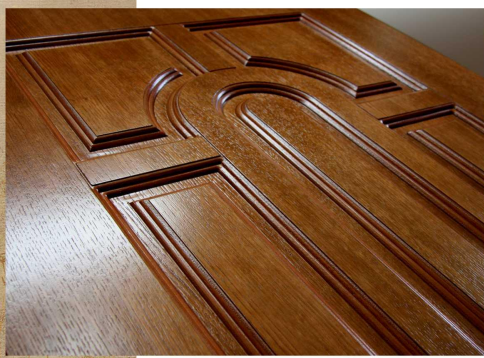



Panel boards

**Naples**

Built-up construction: door collar  
timber – solid oak, door panels –  
vener MDF

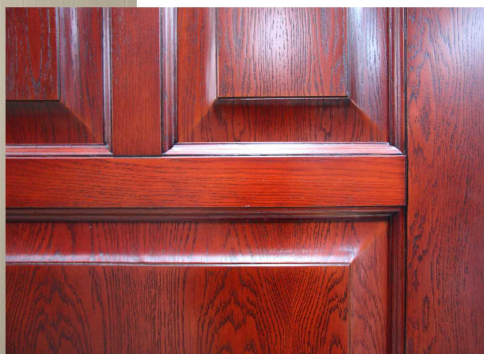

Panel boards

**Palermo**

*Built-up construction with covering,  
door collar timber – solid oak,  
door panels – veneer MDF*

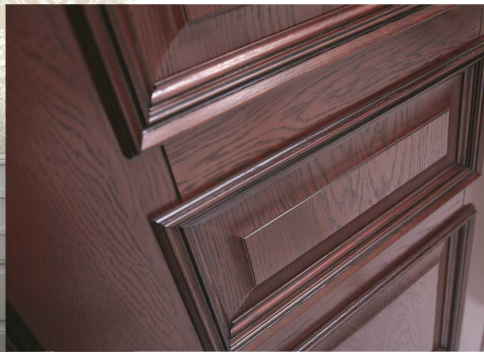

10



11



12



13



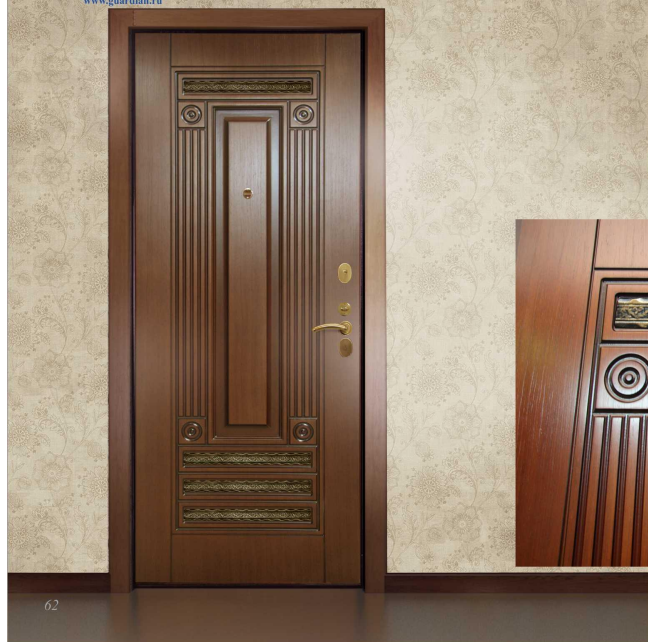

Panel boards

**Italy**

- solid pine / oak
- on the basis of MDF, veneer/ laminated
- italian multilayer plywood

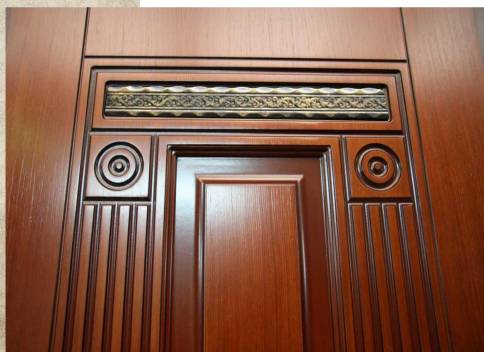

01  
With wrought band



02  
With wrought socklets



03  
With wrought band

Panel boards with mirror

**Venice**

- solid pine / oak
- on the basis of MDF, veneer/  
laminated

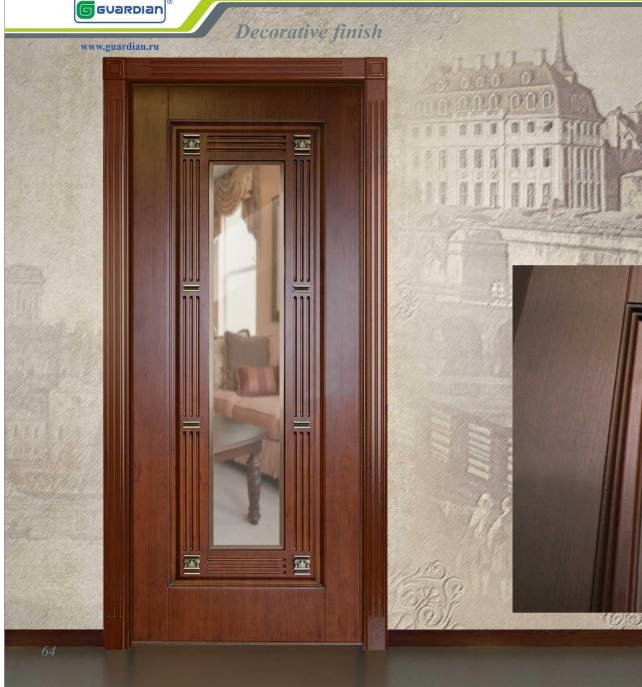

01 With mirror



02

Panel boards

**Verona**

- solid pine/oak
- on the basis of MDF, veneer/  
laminated



01



02



03



04



Fusion-1. Insertion for the panel board «Verona 04»



Fusion-2. Insertion for the panel board «Verona 04»





Panel boards with mirror  
**Narcissus**  
On the basis of MDF, veneer/  
laminated

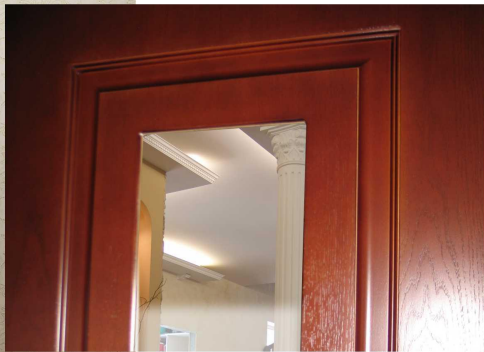

02



04

Decorative finish

Panel boards with mirror  
**Plaza**  
On the basis of MDF, laminated



01



02

Panel boards

**Monarch**

On the basis of MDF, veneer/painted  
with add-on elements

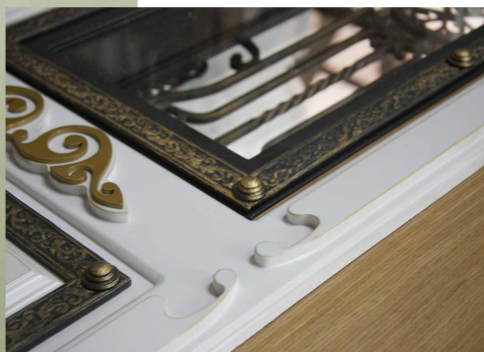

01



02



03



04



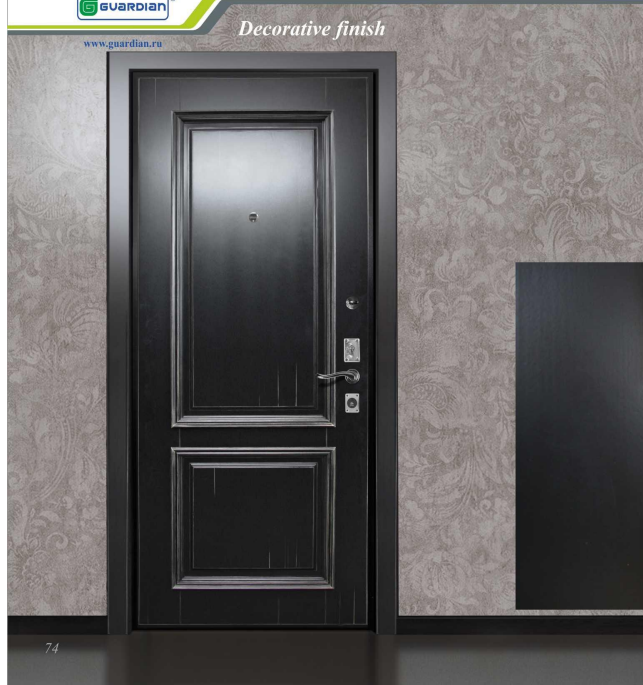

Panel boards

**Royal**

Semi-antique manual handling

- solid pine
- on the basis of MDF, painted



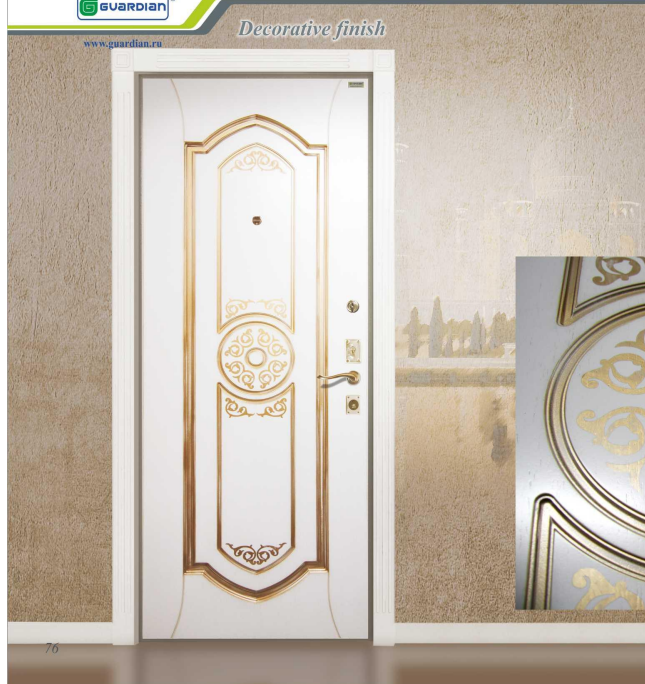

Panel boards  
**Medina**  
On the basis of MDF veneer/painted,  
semi-antique manual handling,  
with ornament and golden patina

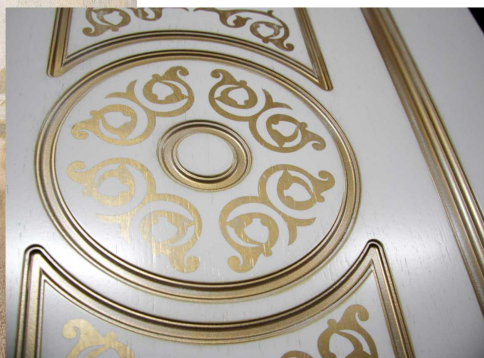

Panel boards  
**Valencia**  
On the basis of MDF  
painted, patinated  
with aerodecoration and hand  
painting



01



02



03



Panel boards

**Florence**

*On the basis of MDF milled, painted with aerodecoration and hand painting*



01.28.14



01.17/49.28



02.17/49.15

Decorative finish

Panel boards  
**Provence**  
On the basis of MDF, milled painted



Decorative finish

Panel boards

**Nika**

- solid oak
- on the basis of MDF, veneer
- on the basis of MDF, painted with the crackle effect
- on the basis of MDF, painted with the ageing effect



01



05



06



07



08



09 (with mirror, made of solid oak only)





Panel boards  
**Premier**

*On the basis of MDF, painted with add-on elements: stainless polished steel element and the element made by laser-beam cutting*



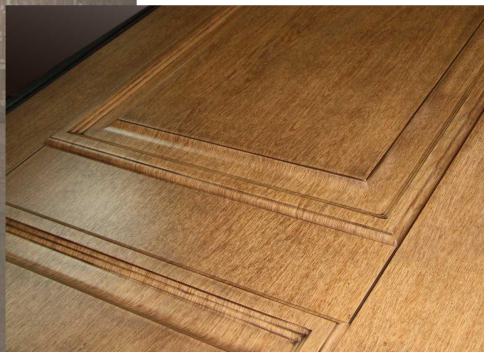

Panel boards

**Geneva**

On the basis of MDF laminated/  
painted



01



02



03



06



07



08

Panel boards

**Quadro**

*On the basis of MDF, milled with built-up construction*

- veneer
- laminated (imitation of the solid panels)
- painted with the unpolished ages metal effect

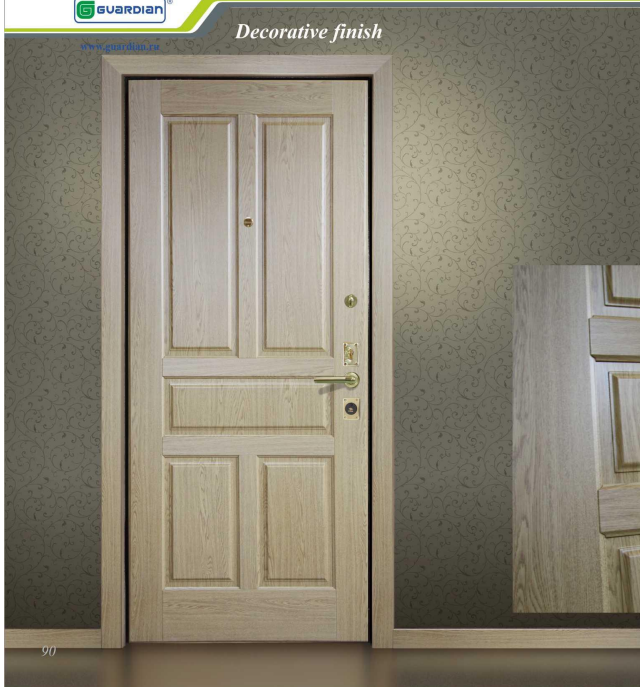

01



02



03



04



05



06

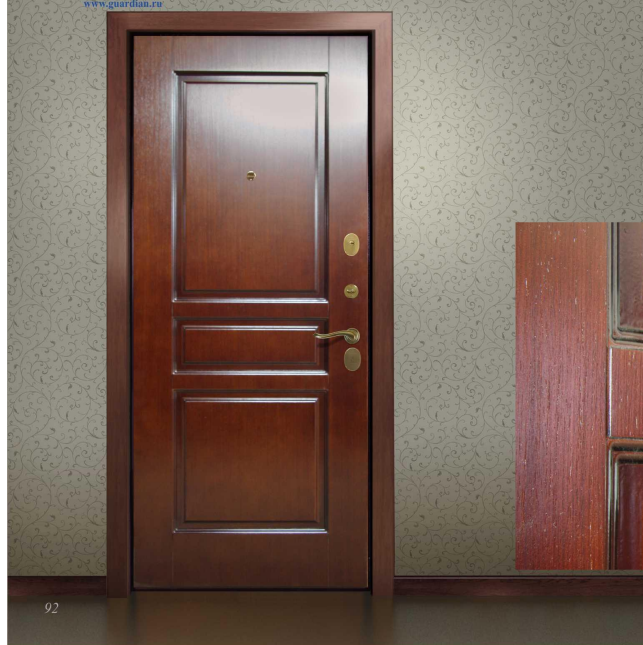

Panel boards  
**Tetra**  
On the basis of MDF, milled veneer,  
laminated



01



02



03



04



06



07



08



09



10



11



Panel boards

**Legend**

On the basis of MDF, veneer with wrought elements

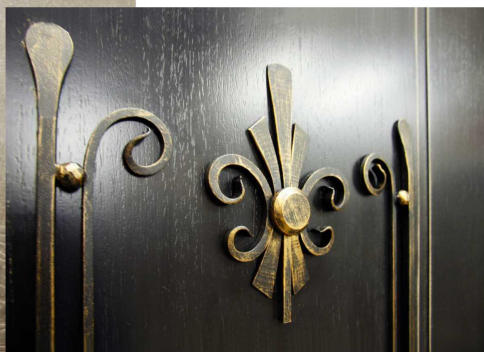

01



02



04



05

Panel boards  
**Alexandria**  
On the basis of MDF, laminated  
with add-on decorative elements



01

02

03

04

05

*Decorative finish*

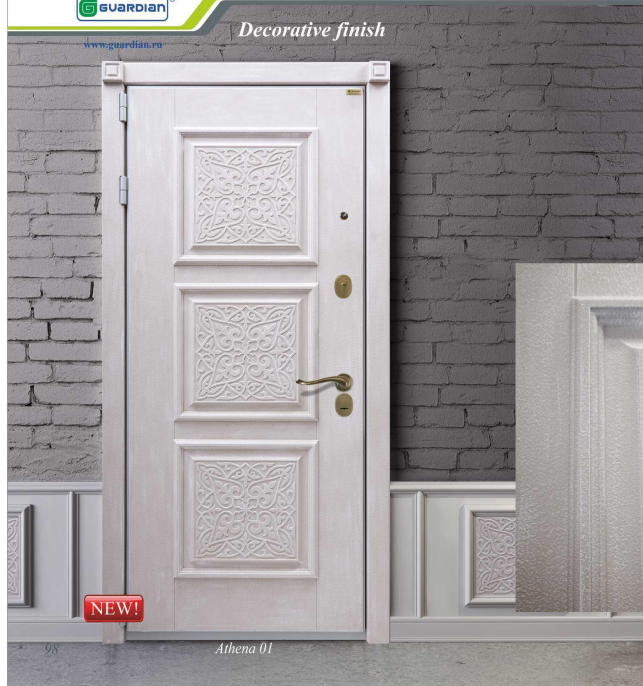

NEW!

Athena 01

*Panel boards*  
**Athena**

*Athena 01 Panel Boards milled as a lithoglyph, which are coated with a special weather-resistant formulation that imitates a stone finish.*



*Panel boards*  
**Athena**

*Athena 02 Panel Boards with inserts of natural stone veneer, which are coated with a special weather-resistant formulation that imitates a stone finish.*

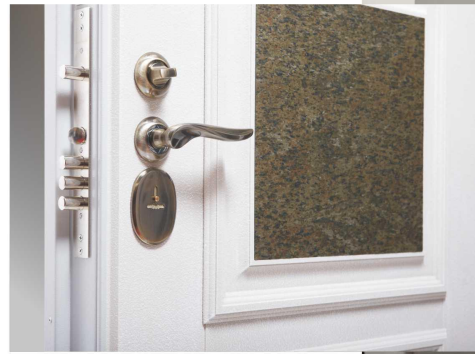

NEW!

Athena 02



Decorative finish

Panel boards  
**Mistral**  
with 3D milling:  
- laminated,  
- painted,  
- multiply plywood

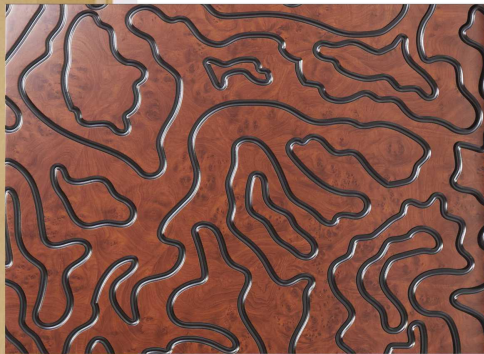
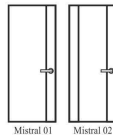



Panel boards

**Milled**

- veneer,
  - laminated,
  - painted,
- on the basis of MDF 12, 16 mm

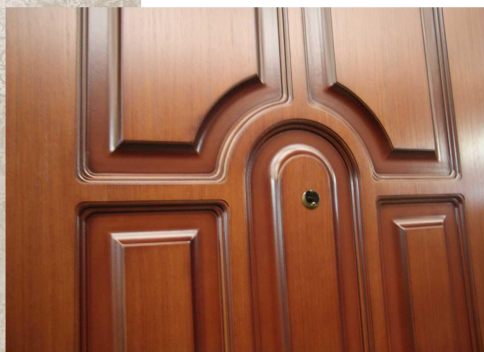



Panel boards  
**Respect**  
On the basis of MDF, veneer  
built-up construction with the inserts



01  
Milled image



02  
Stainless steel elements



03  
Glass elements (white glass)

Panel boards  
**Fusion**

Made with the stainless steel elements  
on the basis of MDF, veneer, with  
built-up construction

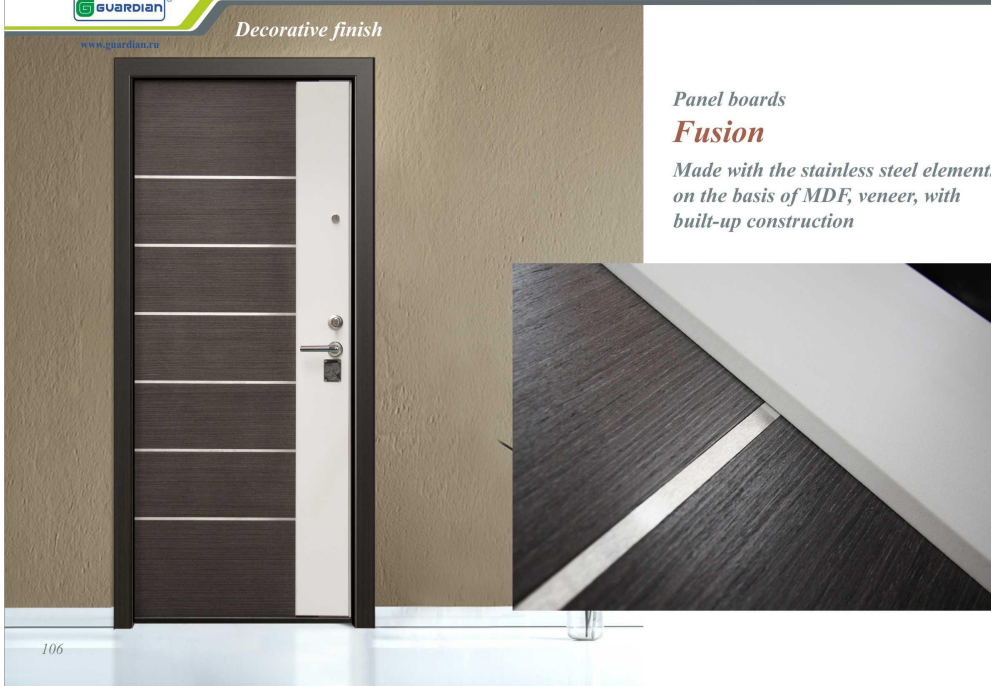

Fusion S 02.black oak



Fusion S 03.black apricot



Fusion S 04.46



Fusion S 04.113/46  
(tinting coating in two colours)



Fusion S 05.black oak



Fusion S 05.46/113  
(tinting coating in two colours)



Fusion S 06.black apricot



Fusion S 06.46/113  
(tinting coating in two colours)



Fusion S 08.113/46  
(Panel Board with a milled element  
and the stainless steel insert)

Panel boards

**Octave**

On the basis of MDF  
veneer / laminated with the glass or  
mirror insertions







Panel boards

**Victory**

Milled, veneer, on the basis of MDF, the milled field is improved by the veneer sheets.

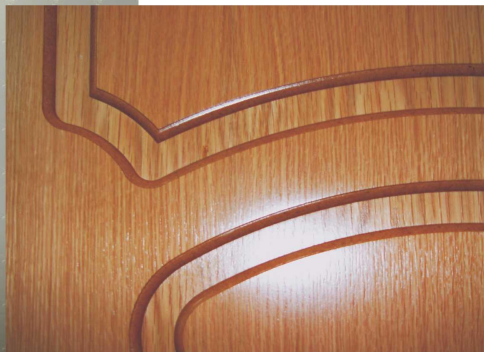

Panel boards

**Neo**

*Milled on the basis of MDF, laminated or veneer, with horizontal placement of the coating structure*

- with the metallised plastic insertions;
- with glass elements and stainless steel inserts



Decorative finish



Enigma 01

Panel boards  
**Enigma**



Enigma 02

On the basis of MDF  
milled  
laminated  
with inking

On the basis of MDF  
milled  
laminated  
with inking



Enigma 03



NEW!

Panel boards

**Sparta**  
**Matador**  
**ML**

Multicolored laminated on the basis  
of MDF



Sparta 01.29/67/35



Sparta 02.08/28/53



Matador 01.01/06



ML 03.38/34



ML 07.54/35/34





Panel boards  
**Metrica**  
Multicolored laminated on the basis  
of MDF

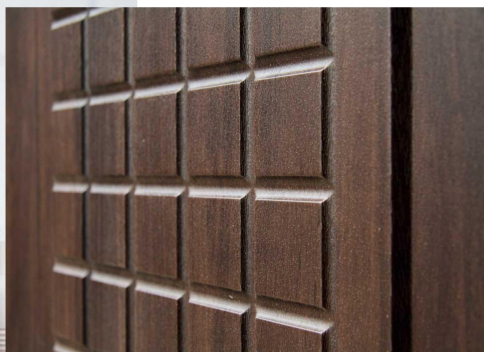

Panel boards  
**LM**  
Multicolored laminated on the basis  
of MDF

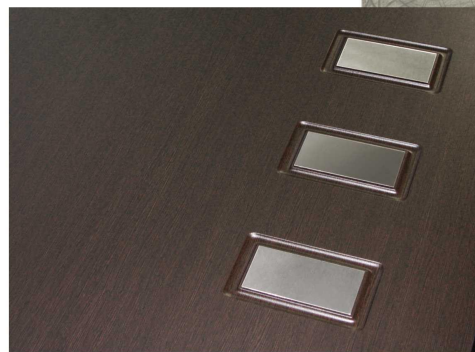

Decorative finish



122

Maya 01

Panel boards

**Maya**

With tribal ornament

- veneer with the solid oak insertion
- laminated with the laminated insertion

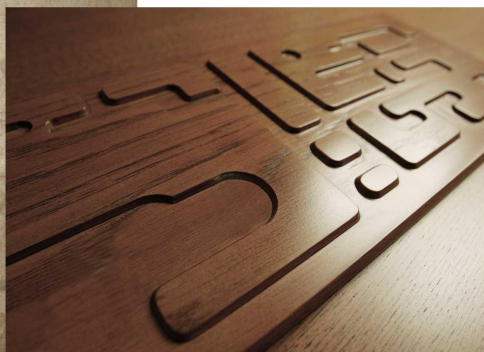

Panel boards

**Maya**

laminated with the laminated insertion

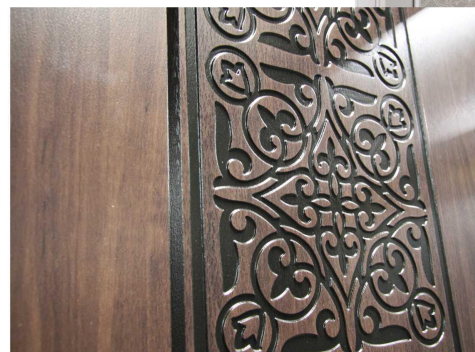

New

Maya 02

123



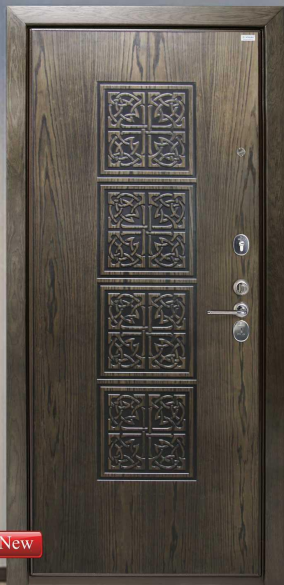

New

Saga 01

Panel boards

**Saga**

*In terms of medium density fibreboard, veneered, stitched, with strong wood grain appearance and with the soft fibres partially removed.*

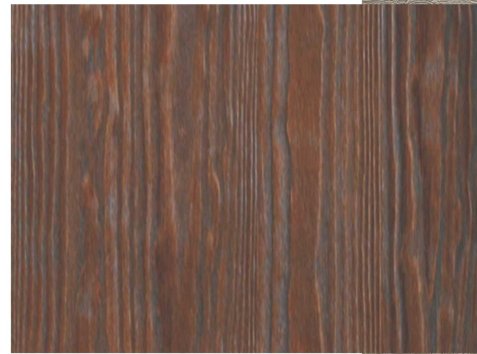
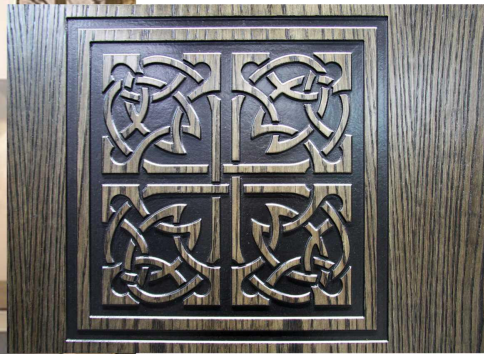

New

Saga 00

*Decorative finish*

*Panel boards*

**Vega**

- laminated
- veneer
- lined with Anti-claw plastic

*Milled on the basis of MDF, with usage of decorative profile – molding*



01



02



03



04



Panel boards

**Milled**

vener/FS/  
laminated/FS/  
painted/FK

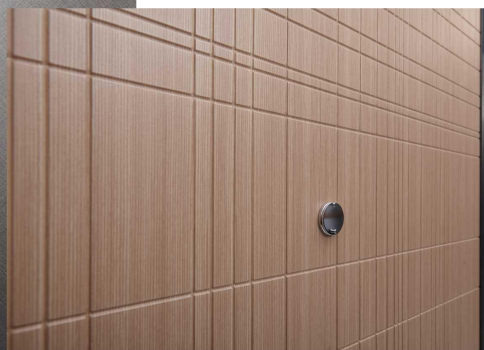

NEW!



NEW!



Panel boards  
**Without ornament**

- laminated
- veneer
- lines with plastic



4 PE 01



6 PE 02



FS 00.01



PL 01 (White polish plastic)



16 FS 00.03/29



FL 00.43



FLN 00.51



Matriks 03



AK 02



AK 08



External finishing



Internal finishing

*finishing*  
**Prestige 01**

- milled panel boards with built-up construction made of multilayer plywood
- biometric access control system
- door step with backlighting
- video communications system

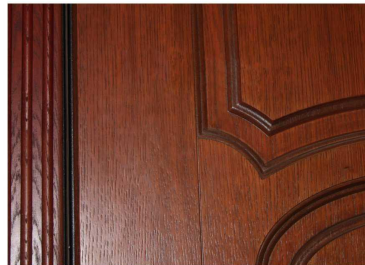

*finishing*  
**Prestige 02**

- milled solid oak panel boards with built-up construction
- biometric access control system
- door step with backlighting
- video communications system



External finishing

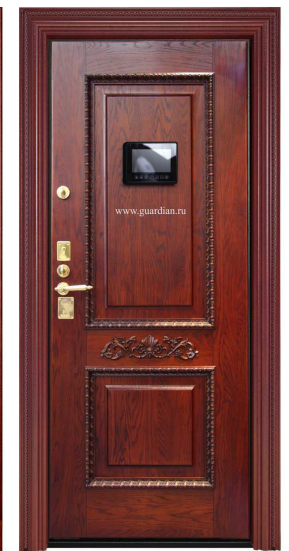

Internal finishing

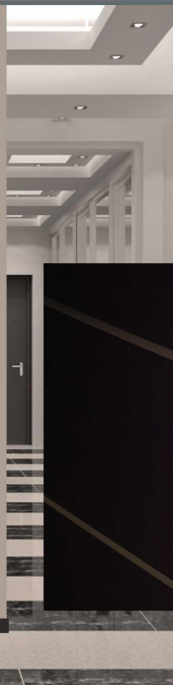

*finishing*

***Prestige 03***

- *hi-tech style external finishing*
- *biometric access control system*
- *door step with backlighting*
- *video communications system*
- *latch area backlight*



*External finishing «Avenue»*

*White polish*



*Internal finishing*

*Prestige 03*





finishing  
**Stealth**

- armour-plated pad
- latch «Cisa 57.665»
- external metal finishing with triplex glass
- door viderviewer
- touch-sensitive door handle
- electric door catch



External finishing

Stealth 01



www.guardian.ru

Stealth 02



www.guardian.ru

Internal finishing

finishing

### Palace

*For installation outdoors*

- painted panel boards on the basis of MDF with the weather-protective coating
- windows with the triple-pane glass framed by the wrought band

- the window bars are made by the laser-beam cutting method, decorated with the forging patina

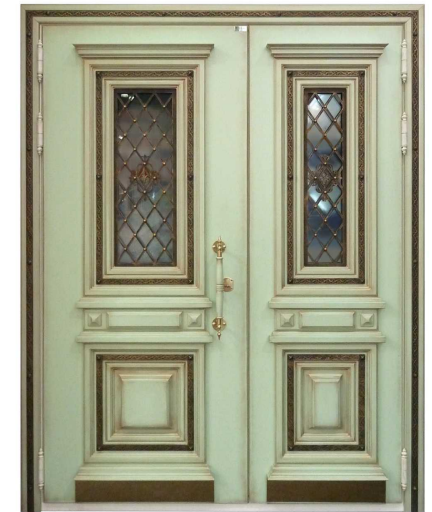
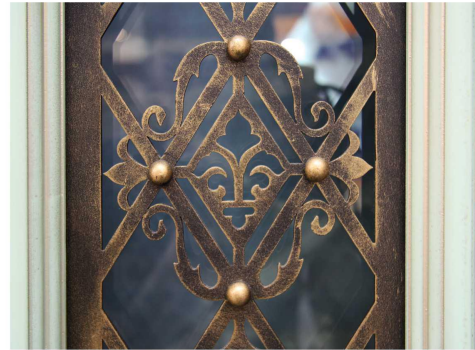
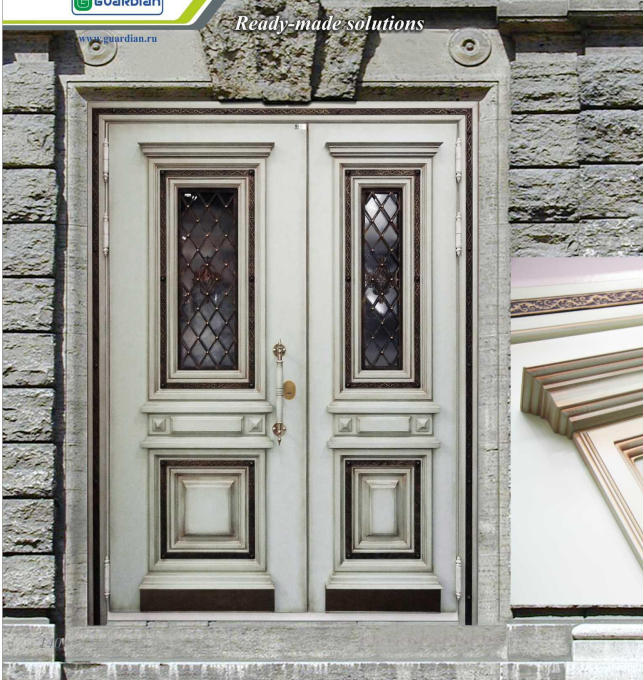

## Lock



«Guardian 12.01» «Guardian 12.11» «Guardian 20.02» «Guardian 22.12» «Guardian 25.12» «Guardian 25.14»  
MAXIMUM



«Guardian 21.14» «Guardian 21.12» «Guardian 40.11» «Guardian 10.01» «Guardian 10.11» «Guardian 15.12» «Guardian 30.01» «Guardian 30.11»  
MAXIMUM

|                              |                                     |                                     |                  |                                     |   |   |                            |                  |                   |                       |                       |   |                   |                   |
|------------------------------|-------------------------------------|-------------------------------------|------------------|-------------------------------------|---|---|----------------------------|------------------|-------------------|-----------------------|-----------------------|---|-------------------|-------------------|
| Dimensions (mm)              | 85 x 82 x 18,5                      | 145 x 82 x 18,5                     | 206 x 136 x 30,5 | 206 x 136 x 30,5                    | 256 x 136 x 30,5                        | 400 x 145 x 30,5                          | 206 x 145 x 30,5           | 206 x 136 x 28,5 | 182 x 135 x 30    | 85 x 82,5 x 18,5      | 130 x 82 x 18,5       | 290 x 81,5 x 18,5                             | 90 x 97,5 x 22    | 138 x 97,5 x 22   |
| Type of mechanism            | cylinder                            | cylinder                            | lever            | cylinder                            | combined                                | combined with the coded rotor             | lever with the coded rotor | lever            | lever             | lever                 | lever                 | combined                                      | lever             | lever             |
| Nomination girth rail (mm)   | 26                                  | 26                                  | 37,7             | 30                                  | 37,7                                    | 37,7                                      | 37,7                       | 37,7             | 18                | 18                    | 26                    | 26  | 26                | 26                |
| Girth rail Diameter (mm)     | 13,5                                | 13,5                                | 18               | 18                                  | 18                                      | 18  | 18                         | 18               | 18                | 13,5                  | 13,5                  | 13,5  | 15,8              | 15,8              |
| Class (GOST 5089-20011)      | 4                                   | 4                                   | 3                | 4                                   | 3                                       | 4   | 4                          | 3                | 4                 | 2                     | 2                     | 2   | 2                 | 2                 |
| Amount of combinations       | depending on the cylinder mechanism | depending on the cylinder mechanism | more than 2 bln  | depending on the cylinder mechanism | lever tumbler mechanism more than 2 bln | lever tumbler mechanism more than 9,7 mln | more than 9,7 mln          | more than 2 bln  | more than 100 mln | more than 46 thousand | more than 46 thousand | Lever tumbler mechanism more than 46 thousand | more than 1,6 mln | more than 1,6 mln |
| Backset (mm)                 | 50                                  | 50                                  | 63               | 63                                  | 63                                      | 63  | 63                         | 63               | 63                | 50                    | 50                    | 50  | 65                | 65                |
| Number of half-turns (lever) | -                                   | -                                   | 4                | -                                   | 4                                       | 4   | 4                          | 4                | 2                 | 2                     | 2                     | 2   | 2                 | 2                 |
| Number of Turns (cylinder)   | 2                                   | 2                                   | -                | 2                                   | 2                                       | 2   | -                          | -                | -                 | -                     | -                     | 2   | -                 | -                 |
| Weight                       | 0,45                                | 0,95                                | 2,7              | 2,47                                | 3,4                                     | 4,84                                      | 3,19                       | 2,92             | 3,5               | 0,73                  | 0,99                  | 1,44  | 0,95              | 1,29              |
| Number of Keys               | 5                                   | 5                                   | 5                | 5                                   | 5 (lever) + 5 (cyl.)                    | 5 (lever) + 5 (cyl.)                      | 5                          | 5                | 5                 | 5                     | 5                     | 5 (lever) + 5 (cyl.)                          | 5                 | 5                 |
| Side                         | standard                            | standard                            | standard         | standard                            | standard                                | left / right                              | left / right               | standard         | left / right      | standard              | standard              | standard                                      | standard          | standard          |

### Lock



«Guardian 30.12» «Guardian 30.15» «Guardian 32.11» «Guardian 32.01» «Guardian 33.11» «Guardian 50.11»  
for PPG-2

|                              |                   |                   |                                     |                                     |                                     |                   |
|------------------------------|-------------------|-------------------|-------------------------------------|-------------------------------------|-------------------------------------|-------------------|
| Dimensions (mm)              | 165 x 97,5 x 22   | 205 x 97,5 x 22   | 156,5 x 97,5 x 22                   | 104 x 97,5 x 22                     | 149,5 x 109 x 21                    | 138 x 97,5 x 22   |
| Type of mechanism            | lever             | lever             | cylinder                            | cylinder                            | cylinder                            | lever             |
| Nomination girth rail (mm)   | 26                | 26                | 26                                  | 26                                  | 26                                  | 26                |
| Girth rail Diameter (mm)     | 15,8              | 15,8              | 15,8                                | 15,8                                | 15,8                                | 15,8              |
| Class (GOST 5089-20011)      | 2                 | 2                 | 4                                   | 4                                   | 4                                   | 3                 |
| Amount of combinations       | more than 1,6 mln | more than 1,6 mln | depending on the cylinder mechanism | depending on the cylinder mechanism | depending on the cylinder mechanism | more than 1,6 mln |
| Backset (mm)                 | 65                | 65                | 65                                  | 65                                  | 65                                  | 65                |
| Number of half-turns (lever) | 2                 | 2                 | -                                   | -                                   | -                                   | 2                 |
| Number of Turns (cylinder)   | -                 | -                 | 2                                   | 2                                   | 2                                   | -                 |
| Weight                       | 1,5               | 1,6               | 1,25                                | 0,87                                | 1,12                                | 1,4               |
| Number of Keys               | 5                 | 5                 | 5                                   | 5                                   | 5                                   | 5                 |
| Side                         | standard          | standard          | standard                            | standard                            | left / right                        | standard          |



«Guardian 50.15» «Mottura 52.Y515» MK «Mottura 54.Y916» MK «Cisa 57.665» «Cisa 57.966» «Guardian EML 1.2» electromechanical lock

|                              |                   |  |  |   |   |  |
|------------------------------|-------------------|--|--|---|---|--|
| Dimensions (mm)              | 205 x 97,5 x 22   | 203 x 137 x 30,5                               | 289 x 137 x 30,5                               | 206 x 136 x 30                                | 290 x 125 x 30                                | 160 x 82 x 25  |
| Type of mechanism            | lever             | lever with possibility of recoding             | combined with possibility of recoding          | lever with possibility of recoding            | combined with possibility of recoding         | case with electric actuator, control means, two pendants |
| Nomination girth rail (mm)   | 26                | 40   | 40   | 38  | 38  | 20   |
| Girth rail Diameter (mm)     | 15,8              | 18   | 18   | 18  | 18  | 18   |
| Class (GOST 5089-20011)      | 3                 | 4  | 4  | 4   | 4   | -  |
| Amount of combinations       | more than 1,6 mln | lever tumbler mechanism more than 144 thousand | lever tumbler mechanism more than 144 thousand | lever tumbler mechanism more than 70 thousand | lever tumbler mechanism more than 70 thousand | -  |
| Backset (mm)                 | 65                | 85   | 85   | 84  | 84  | -  |
| Number of half-turns (lever) | 2                 | 4  | 4  | 4   | 4   | -  |
| Number of Turns (cylinder)   | -                 | -  | 2  | -   | 2   | -  |
| Weight                       | 1,8               | -  | -  | -   | -   | 0,8  |
| Number of Keys               | 5                 | 5  | 5 (lever) + 5 (cyl.)                           | 5   | 5 (lever) + 5 (cyl.)                          | -  |
| Side                         | standard          | left / right                                   | left / right                                   | left / right                                  | left / right                                  | standard   |



Door viewers

Ø 16 mm. Digital door videoviewer «Omega», «Smart».



Door videoviewer «Omega» Door videoviewer «Smart»

Digital door videoviewer is a modern device replacing the traditional door viewers. Digital door viewer is convenient and easy to use, the screen shows the image of what is happening behind your door.

Ø 24 mm. Periscopic door viewer



«Periscopic» chrome

Periscopic door viewers of the unique design provide the safe and complete (200 degrees) review of space behind the door. They are made according to the principle of submarine periscope which eyepiece and lens are not coaxial. The periscopic door viewer is designed for safe, high-quality and complete (200°) review of the area behind the door. It uses a high-quality glass optics.

Ø 24 mm. Door viewers with enhanced optical efficiency — «USL», «USH»



«USH»

«USL»

This optical system consists of 4 glass lenses of large diameter. The glass optics provides the viewing angle of 200 degrees that reduces the distortion in operation sector of 180 degrees. The door viewers with optical efficiency allow to see well in the case of low light. The door viewers are equipped with a shutter. The shutter is easily and quietly closed, tightly covers the opening of the eyepiece, does not have sharp edges and does not touch the decorative panel boards while moving.

Ø 23 mm. Door viewer «De Luxe»



«De Luxe» brass

«De Luxe» chrome

High-aperture door viewer with the tinted lens has the viewing angle of 200 degrees. The door viewers allow seeing well in low light, they are equipped with a shutter. The soft-running shutter tightly covers the opening of the eyepiece, does not have sharp edges and does not touch the decorative panel boards while moving.

Ø 23 mm. Bulletproof door viewer



«PNL»

«PNH»

The bullet from short-barrelled firearms does not break the door viewer, partially damaging the lens and not causing harm to the observer. The door viewer is composed of two interconnected metallic cylinders. There are 7 lenses inside of it. When fired, the first lens is broken, the next two or three lenses are damaged, but they are not broken.

Ø 16 mm. Door viewer «Armadillo»



«Armadillo» brass

«Armadillo» chrome

Installed in the basic set. Plastic optics.

Ø 16 mm. Door viewer «Apecs»



«Apecs» brass

«Apecs» chrome

«Apecs» bronze

Installed in the basic set. Plastic optics.

Rotators, door bolts, changeable mechanisms



«Multitilo» rotator brass, chrome



«Omega» rotator brass, chrome, bronze



«Venus» rotator brass, chrome

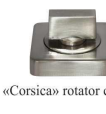

«Corsica» rotator chrome



«Apecs» the door check, chrome

Door check is designed for use in temperatures as low as -40 °C. The system's two independent valves can be adjusted to set the closing and slam speeds to the user's preferences. This type of door check is designed for installation both on exterior doors, and on for use with the domestic doors. The maximum door opening angle – is 180°.

«Apecs» bolt mechanism, chrome



«Apecs» front door bolt, chrome (for the double-leaf doors)



Changeable mechanisms



«Rotor-lock» (for «Guardian» lock)



«Cambio» (for «Cisa» lock)



«Nucleo» (for «Mottura» lock)

Door handles



«Omega 24» bronze

«Persea» brass



«Alfa 26» , brass



«Eco» brass



«Alfa 26», chrome



«Eco» chrome



«Omega 26», brass



«Omega 26», chrome



«Piata», brass



«Piata», chrome



«Omega 28», brass



«Omega 28», chrome



«Asia», brass



«Asia», chrome



«Amelia», brass «Amelia», chrome  
(for the «Guardian 30.12» lock)



«Corsica»,chrome



«KEA», chrome



«Bella», brass «Bella», chrome  
(for «Guardian 10.11», «Guardian 30.11» lock)



«Gretta», brass «Gretta», chrome  
(for «Guardian 15.12», «Guardian 33.11» lock)



«Apecs» door pull, chrome



«Impero» door pull, brass

Organizations may only utilize the products sold under the "Guardian" trademark if they agree to the terms of use of the trademark "The Guardian". The "Guardian" company has not subsidiaries.

*Door trim, precast door frames with decorative elements, moulding for doors*



Variants of the door trims



- 1. Decorative element
- 2. Door trim
- 3. Precast door frames



Moulding 01

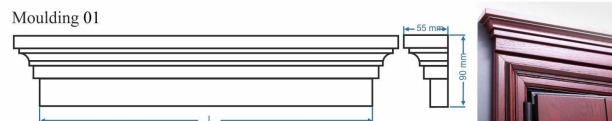

Moulding 02

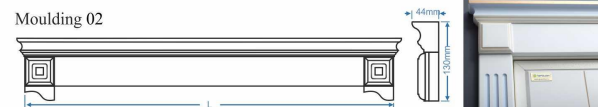

Door's plintblok

